

WETRO 1.0/2.0/3.0

INSTALLATION INSTRUCTIONS | DECEMBER 2022

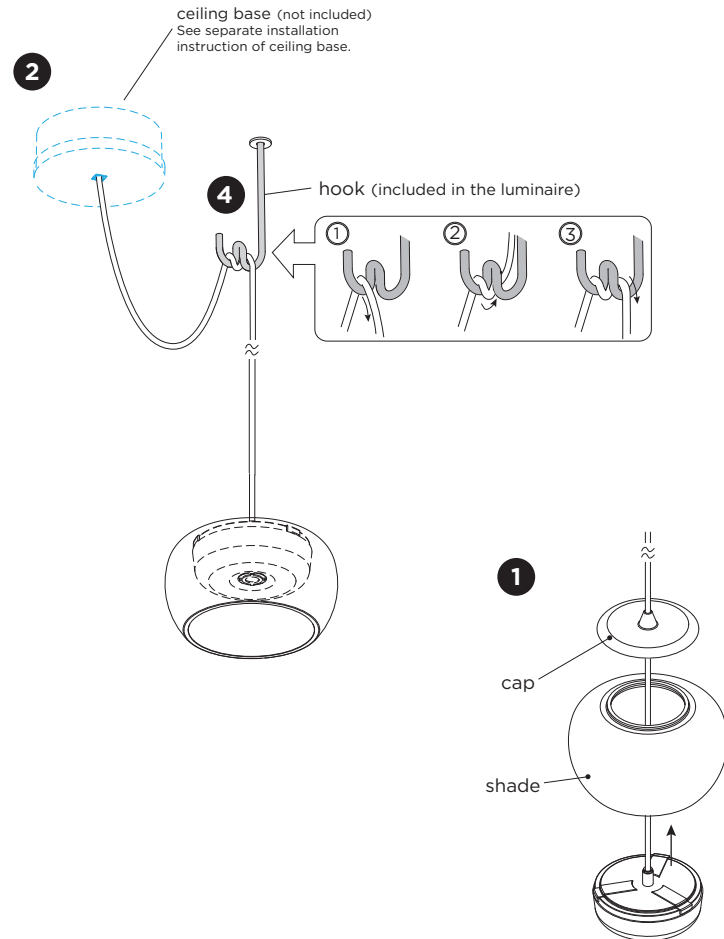

DIMENSIONS

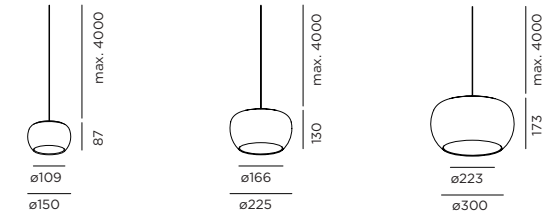

WETRO 1.0

WETRO 2.0

WETRO 3.0

MOUNTING INSTRUCTION

1 Pass the cable of the LED module through the glass shade and the cap.

2 **POWER CONNECTION**
Connect to 220-240V.
Connect the wires in the ceiling base (see separate instructions manual from the ceiling base).



3 Tighten the cap after balancing the glass in a straight way by screwing it on the LED module.

4 Optionally use the hook to support the cable.

WETRO 1.0/2.0/3.0

INSTALLATION INSTRUCTIONS | DECEMBER 2022

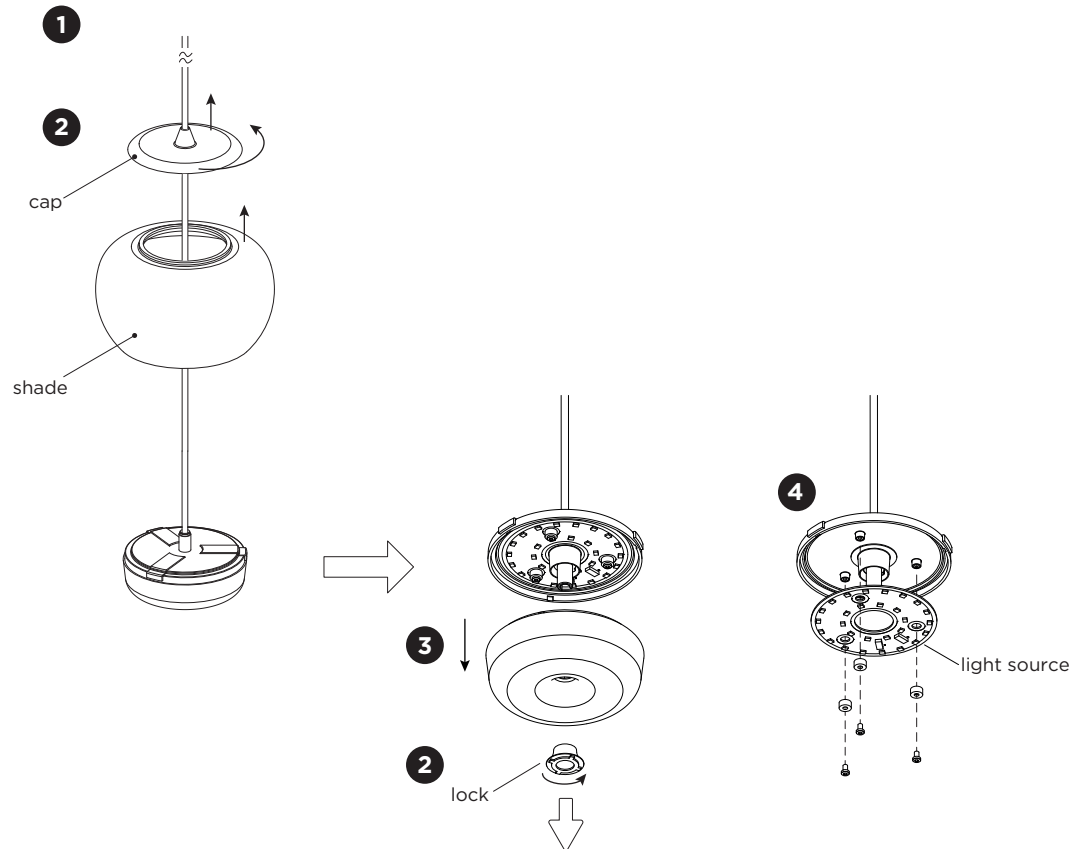

DISMOUNTING AND RECYCLING INSTRUCTIONS

Light source

- 1** Loosen the wires from the power connection (see separate instructions manual from the ceiling base).
- 2** Turn the cap counter clockwise. Remove the cap and the shade from the fixture.
- 3** Remove the lock by turning it counter clockwise.
- 4** Remove the cover.
- 5** Loosen the screws and wires to remove the light source.

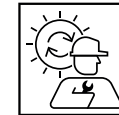

The light source is replaceable by an authorized professional. For advice contact your Wever & Ducre customer service contact point.



This luminaire contains a light source with the energy class G.